

5 DIGITAL LCD MICRO-PROCESS METER (24x48mm) **LCD5X-AS**



FEATURES

- Accuracy: $\pm 0.05\%$ F.S. ± 1 digit
- Measuring AC, DC Voltage / AC, DC Current / Potentiometer / PT-100 / Load Cell
- High brightness LCD background display range: -19999~99999; decimal point selectable
- Meter depth 48.5 mm, easily installation
- CE approval

ORDER INFORMATION: LCD5X-AS- [Code 1] [Code 2] - [Code 3] - [Code 4]

| Code 1 | Input Type | Code 2 | Voltage | Code 2 | Current | Code 2 | Potentiometer | Code 2 | Resistor | Code 2 | RTD (PT-100) | Code 2 | Load Cell | Code 3 | Aux. Power |
|--------|----------------------|--------|---------|--------|---------|--------|-----------------------------|--------|-----------------|--------|-----------------------|--------|--------------|--------|--------------|
| D | DC | V1 | 0~50mV | A1 | 0~20uA | P1 | 500 Ω ~10K Ω | I1 | 0~10 Ω | T1 | -50~50 $^{\circ}$ C | L1 | 1mV/V EX.5V | A | AC/DC20~240V |
| A | AC AVG | V2 | 0~5V | A2 | 0~200uA | P2 | 10K Ω ~100K Ω | I2 | 0~100 Ω | T2 | -100~100 $^{\circ}$ C | L2 | 2mV/V EX.5V | C | DC 5~30V |
| M | AC TRMS | V3 | 1~5V | A3 | 0~2mA | P3 | 100K Ω ~1M Ω | I3 | 0~1K Ω | T3 | -200~200 $^{\circ}$ C | L3 | 3mV/V EX.5V | | |
| P | 3 Wire Potentiometer | V4 | 0~10V | A4 | 0~20mA | PO | Option | I4 | 0~10K Ω | T4 | 0~600 $^{\circ}$ C | L4 | 1mV/V EX.10V | | |
| I | 2 Wire Resistor | V5 | 0~36V | A5 | 0~200mA | | | I5 | 0~100K Ω | TO | Option | L5 | 2mV/V EX.10V | | |
| T | RTD (PT-100) | V6 | 0~300V | A6 | 4~20mA | | | IO | Option | | | L6 | 3mV/V EX.10V | | |
| L | Load Cell | V7 | 0~600V | A7 | 0~2A | | | | | | | LO | Option | | |
| 2 | 2, 3 Wire Sensor | VO | Option | A8 | 0~5A | | | | | | | | | | |
| 4 | 4 Wire Sensor | | | AO | Option | | | | | | | | | | |

SPECIFICATION

- ◆ Accuracy: 0.05% F.S. ± 1 digit
- ◆ Sampling Cycle: 16 cycles/sec. (>10Hz)
- ◆ Display Rang: -19999~99999
- ◆ Temp. Coefficient: 50ppm/ $^{\circ}$ C (0~50 $^{\circ}$ C)
- ◆ Display Screen: Red high efficiency LEDs high 10.16mm(0.4")
- ◆ Parameters Setting: Touch switches
- ◆ Back Up Memory: Non-volatile EEPROM memory
- ◆ Surge Test: 1.5KVac/1min. (input/power/display)
- ◆ Exciting Power: 12VDC $\pm 3\%$ (<50mA)
- ◆ Operating Temp.: 0~50 $^{\circ}$ C (20 to 90% RH non-condensed)
- ◆ Storage Temperature: 0~70 $^{\circ}$ C (20 to 90% RH non-condensed)

DIMENSION

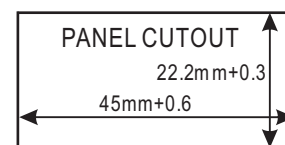
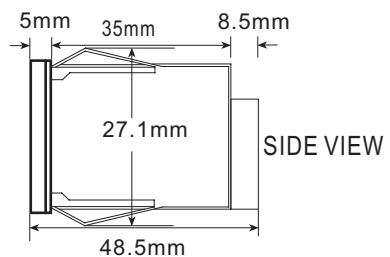

WIRING CONNECTION

